

# TELECOM VAULT

## NOTES:

- CONCRETE: 5000 psi @ 28 days
- REF: Cover Slab - #7 rebar @ 6" o.c. in short direction
- #6 rebar @ 11" o.c. in long direction
- (2" conc cover from bottom up)
- Riser #1 - #5 rebar @ 6" o.c. in horizontal dir.
- #5 rebar @ 12" o.c. in vertical direction
- (2" conc cover from inner core)
- Base Riser - #4 rebar @ 8" o.c. both directions
- (2" conc cover from inner core)
- Base - #6 rebar @ 6" o.c. in short direction
- #5 rebar @ 6" o.c. in long direction
- (2" conc cover from top down)
- Additional rebar - #5 rebar bent "L"s from base to wall @ 8" o.c. (18" x 18" tails)
- Rebar diamond around all openings
- OPENINGS: 21" x 21" knockouts (location to be determined by contractor)
- LIFTING: PA lifting cables as shown on detail
- CASTING: supplied by contractor
- JOINT: Cor-Seal CS-102 butyl seal

Weight:  
 Base & Riser: 12,100#  
 Riser #1: 13,900#  
 Cover: 8,800#

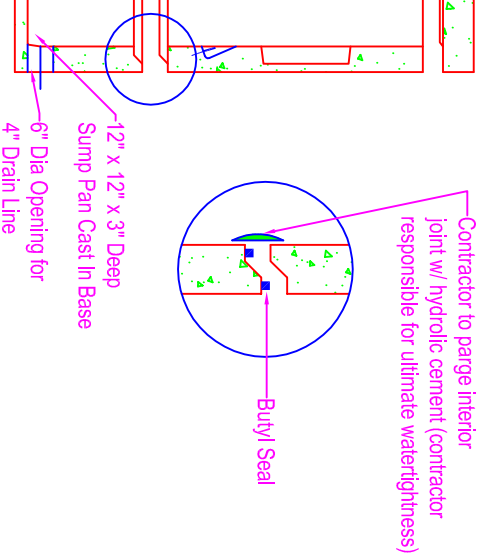
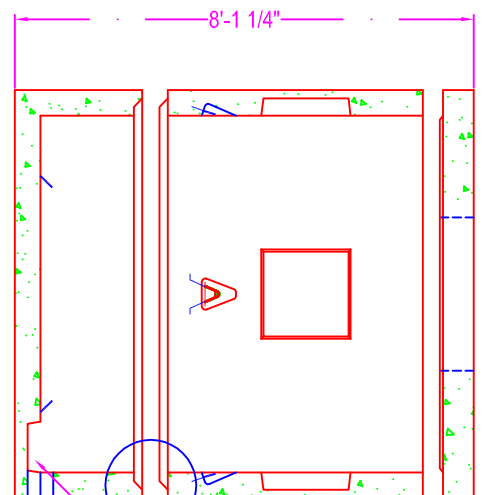
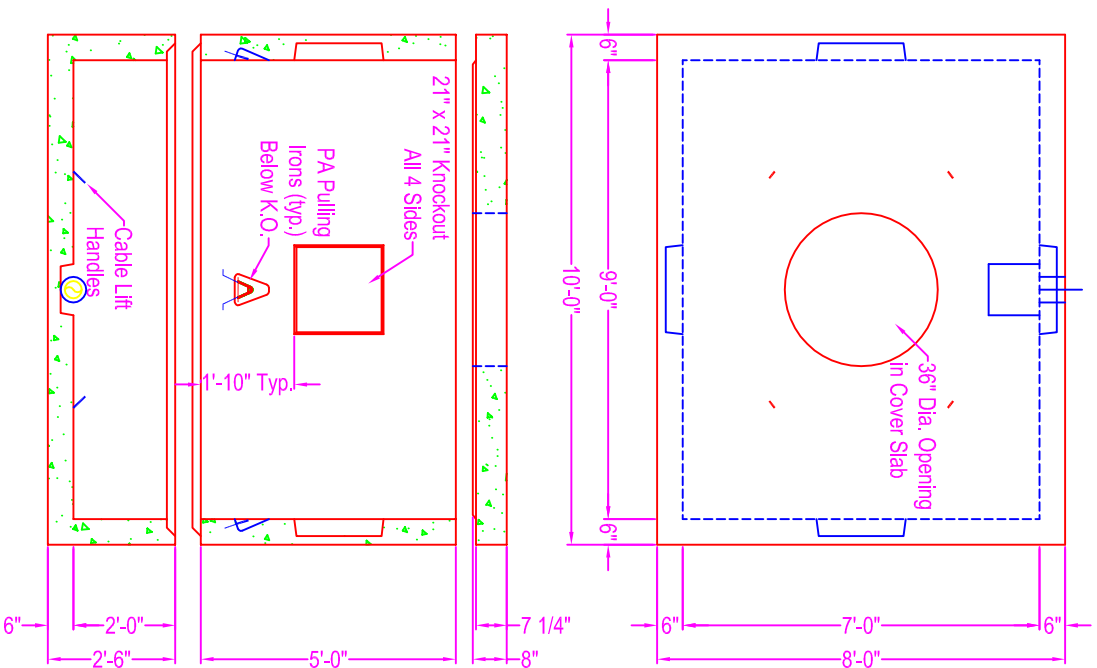

Contractor to parge interior joint w/ hydraulic cement (contractor responsible for ultimate watertightness)

Butyl Seal

12" x 12" x 3" Deep Sump Pan Cast In Base  
 6" Dia Opening for 4" Drain Line

Zeiser

Wilbert  
 VAULT INC.

CONCRETE PRODUCTS

750 Howard Street Elmira, NY 14904

Fax: (607) 737-0291

Phone: (607) 733-0568

1-800-472-4335

Title: Telecom Vault

Scale: Not To Scale

Drawn By: JPS

Drawing No.: 02180800

Date: 2-18-08