

ELECTRIC VAULT PAD

NOTES:

- CONCRETE: 5000 psi @ 28 days
- REF: #4 rebar @ 8" o.c. each way in walls
- #4 bent rebar on corners, top, bottom, and middle
- #4 rebar 6" o.c. each way in bottom
- PA Insert Lifting Handles in 2 walls
- OPENINGS: knockout all 4 sides

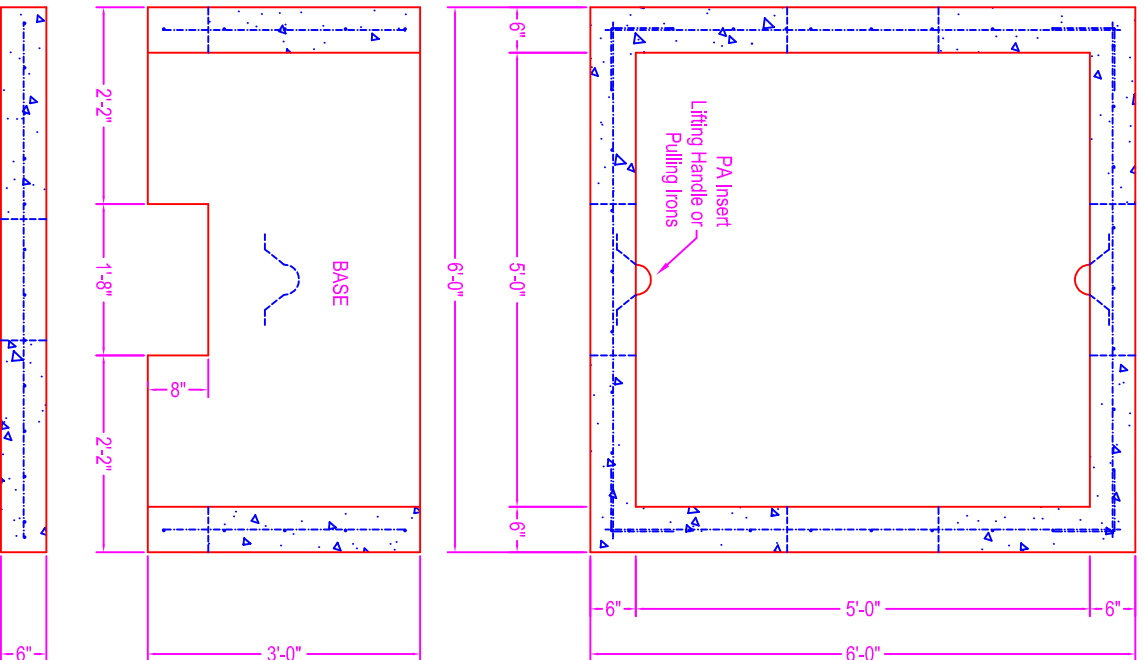

BOTTOM-Optional

Zeiser

Wilbert
VAULT, INC.

CONCRETE PRODUCTS

750 Howard Street Elmira, NY 14904

Fax: (607) 737-0291

Phone: (607) 733-0568

1-800-472-4335

Title: 6' x 6' Elec. Vault Pad

Scale: Not To Scale

Drawn By: JPS

Drawing No.: 1065

Date: 3-13-00