

NYS DOT 655-6R1 Rectangular Grate

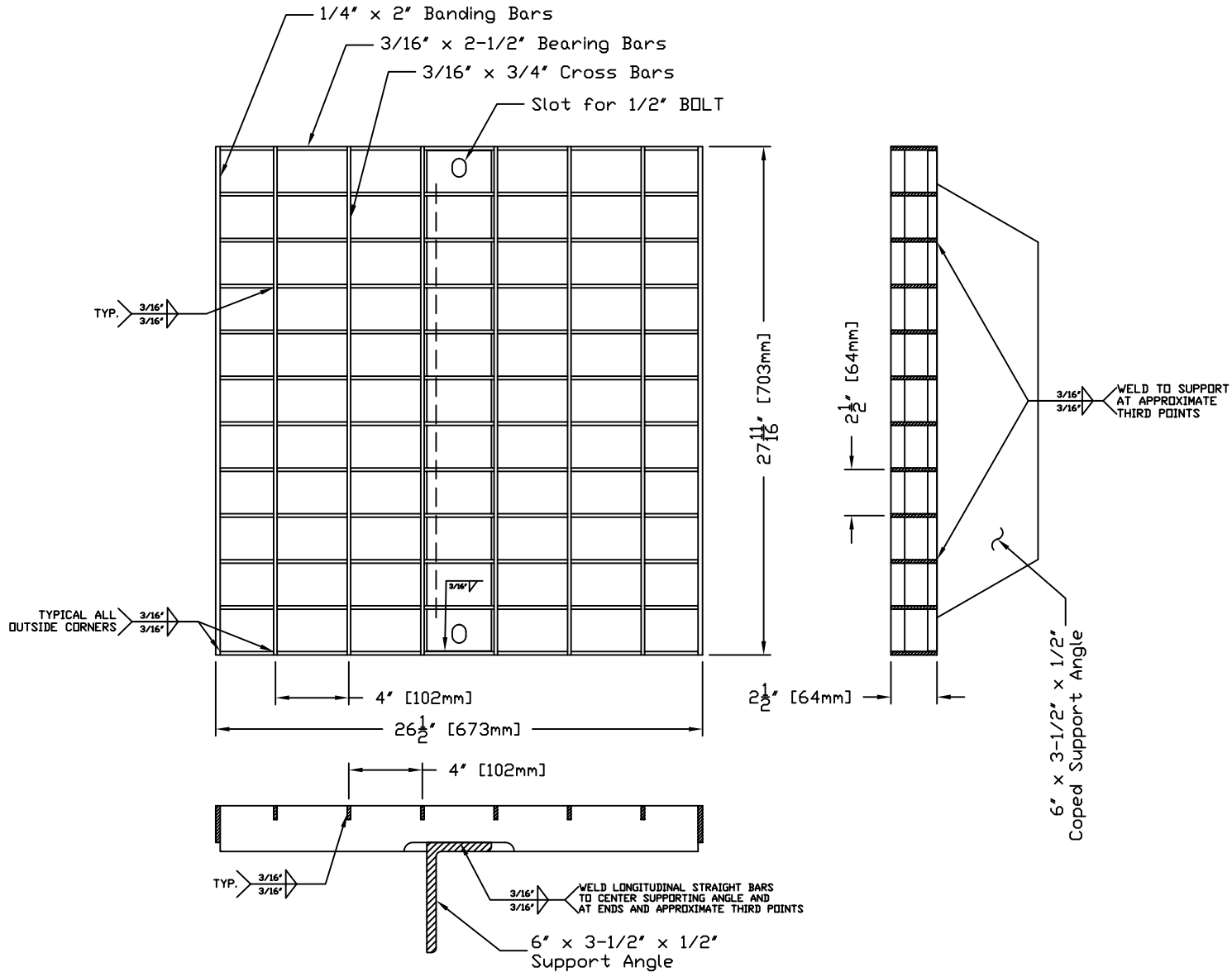

Product Number
 6556R1G-09

Design Features

- Materials
 Hot Rolled Steel
- Design Load
 Per NYSDOT Standard Sheet 655-6R1

- Coating
 Galvanized

Certification

- WT 91 lbs
- Country of Origin: Made in USA

Drawing Revision

01/15/14 Designer: TJM
 Revised By:

Disclaimer

Weights (lbs/kg), dimensions (inches/mm) and drawings provided for your guidance. We reserve the right to modify specifications without prior notice.

CONFIDENTIAL: This drawing is the property of EJ Group, Inc. and embodies confidential information, registered marks, patents, trade secret information, and/or know-how that is the property of EJ Group, Inc. Copyright © 2011 EJ Group, Inc. All rights reserved.

Contact

800 626 4653
 ejco.com

3/16" x 2-1/2" BEARING BARS SHALL BE HOT ROLLED STEEL CONFORMING TO ASTM A1011.

3/16" x 3/4" CROSS BARS SHALL BE HOT ROLLED STEEL CONFORMING TO ASTM A1011.

ALL OTHER MATERIAL SHALL BE HOT ROLLED STEEL CONFORMING TO ASTM A36.

ALL STEEL SHALL BE MADE FROM DOMESTIC MILLS ONLY (MADE IN USA).

GRATE SHALL BE GALVANIZED IN CONFORMANCE WITH SUBSECTION 719-01 TYPE 1 OF THE NYSDOT STANDARD SPECIFICATIONS, ASTM A123 AFTER FABRICATION.

EACH UNIT SHALL BE FABRICATED PER NYSDOT STANDARD SHEET 655-01.