

# 4 1/2" FRAME (SCSC 2816)

ONY541900001



## 5419Z Frame



00541913

Quantity: 1

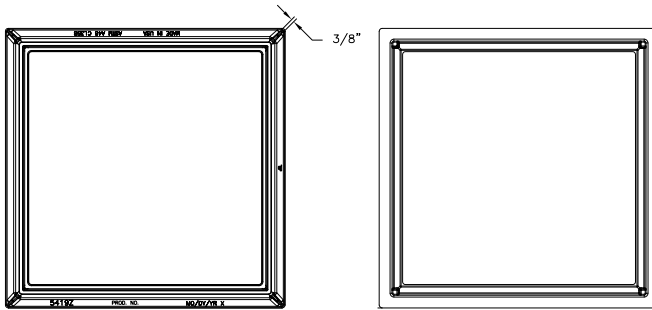

### Product Number

00541913

### Design Features

- Materials
  - Gray Iron (CL35B)
- Design Load
  - Heavy Duty
- Open Area
  - n/a
- Coating
  - Undipped
- √ Designates Machined Surface

### Certification

- ASTM A48
- 
- Country of Origin: USA

BOTTOM VIEW

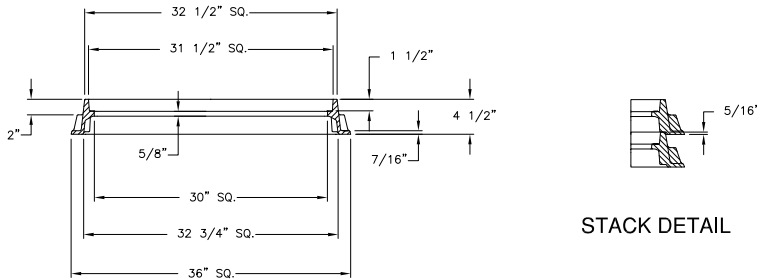

### Drawing Revision

04/12/2006 Designer: DEW  
09/25/2014 Revised By: DAE

### Disclaimer

Weights (lbs./kg), dimensions (inches/mm) and drawings provided for your guidance. We reserve the right to modify specifications without prior notice.  
CONFIDENTIAL: This drawing is the property of EJ GROUP, Inc., and embodies confidential information, registered marks, patents, trade secret information, and/or know how that is the property of EJ GROUP, Inc. Copyright © 2015 EJ GROUP, Inc. All rights reserved.

**Contact**  
800 626 4653  
ejco.com

SECTION

STACK DETAIL

### Disclaimer

Weight (lbs./kg), dimensions (inches/mm) and drawings provided for your guidance. We reserve the right to modify specifications without prior notices

CONFIDENTIAL: This drawing is the property of EJ GROUP, Inc., and embodies confidential information, registered marks, patents, trade secret information, and/or know how that is the property of EJ GROUP, Inc. Copyright © 2015 EJ GROUP, Inc. All rights reserved

**Contact**  
800 626 4653  
ejco.com