

# DISTRIBUTION BOX

1-INLET  
8-OUTLETS

NOTES:

CONCRETE: 5000 psi @ 28 days  
 POLYPROPYLENE FIBERS  
 REF.: #3 rebar & 4x4 12.5 mesh  
 in box  
 #3 rebar in cover  
 PIPE CONNECTS: polylok

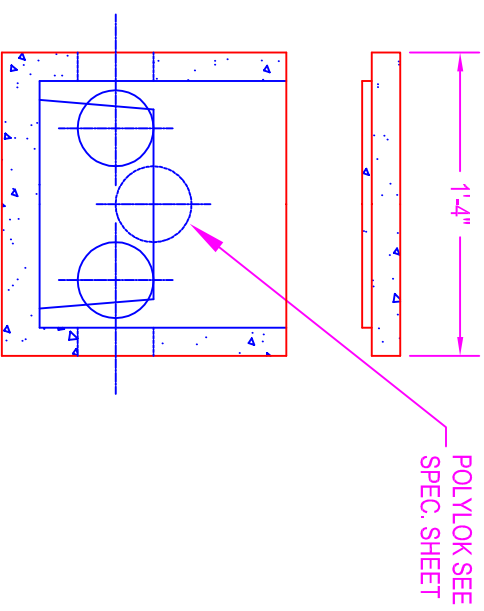
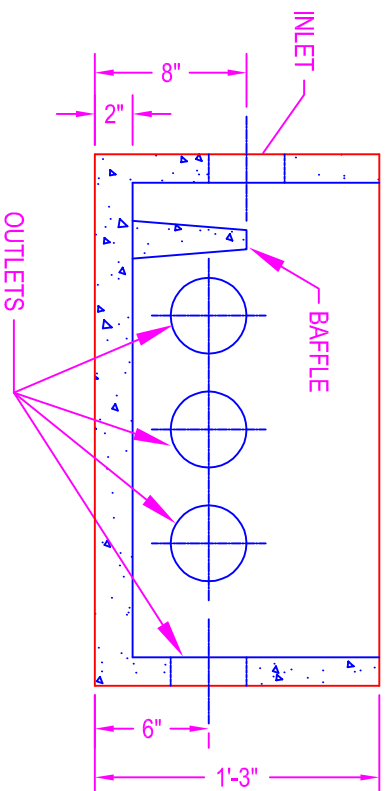
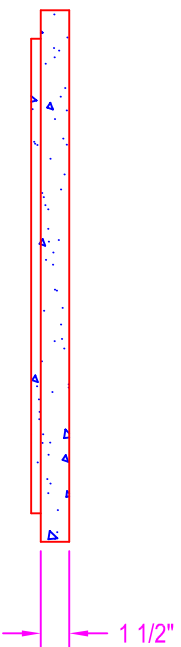
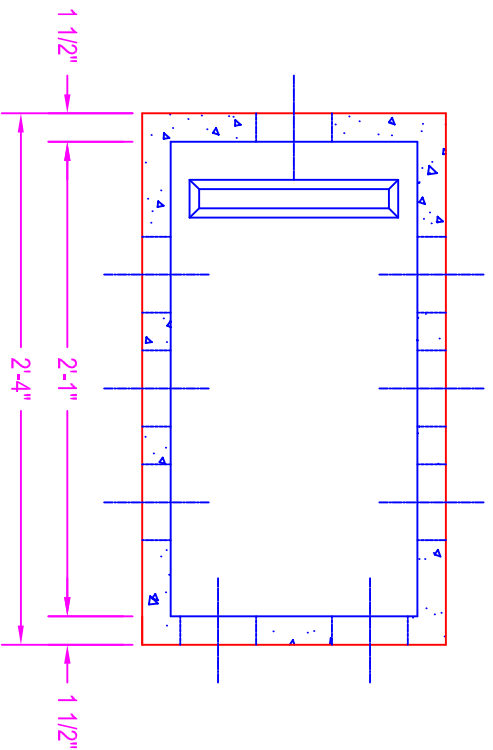

**Zeiser**

**Wilbert**  
VAULT, INC.

CONCRETE PRODUCTS

750 Howard Street Elmira, NY 14904

Fax: (607) 737-0291

Phone: (607) 733-0568

1-800-472-4335

**Title: 8 HOLE DB**

Scale: Not To Scale

Drawn By: JPS

Drawing No.: 1033

Date: 11-22-99