

# SEPTIC TANK ST-2500

3-INLETS  
3-OUTLETS

NOTES:

- CONCRETE: 5000 psi @ 28 days
- REF: no fiber mesh
- rebar grade 60 ASTM A615
- ENTRAINED AIR: +/- 5% to 8%
- DESIGN LOAD: HS-20 design load
- LIVE LOAD: N/A
- EARTH FILL: 24" max fill depth
- BUOYANCY FACTOR: N/A
- PIPE CONNECTS: polylok (cast in)
- BAFFLE: plastic baffle w/ gas deflector on outlet opening
- plastic baffle on inlet

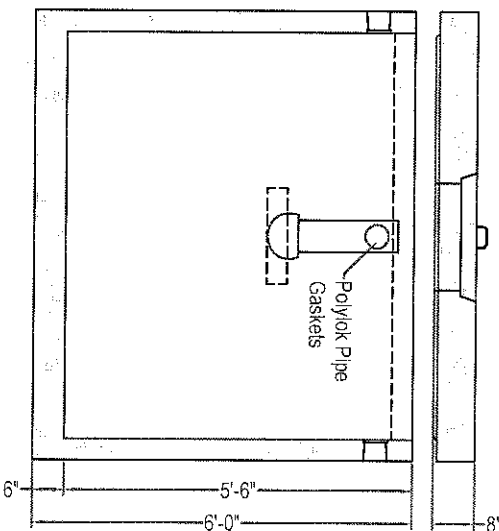
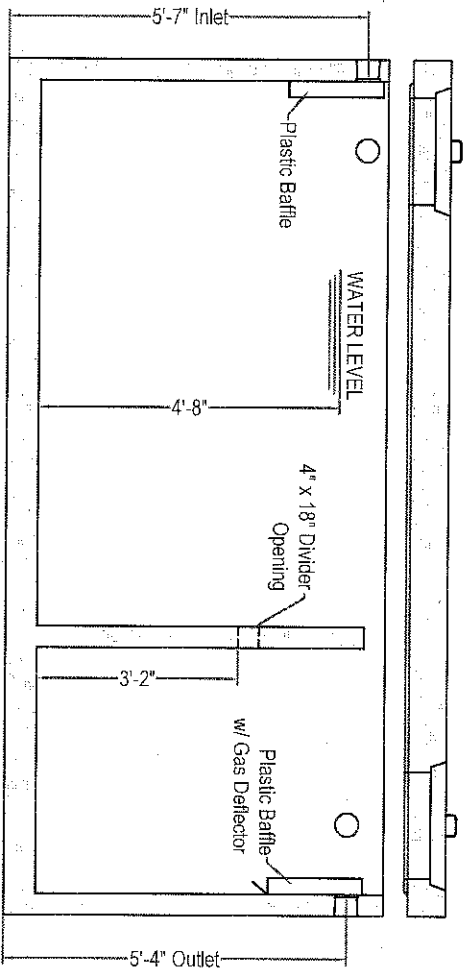
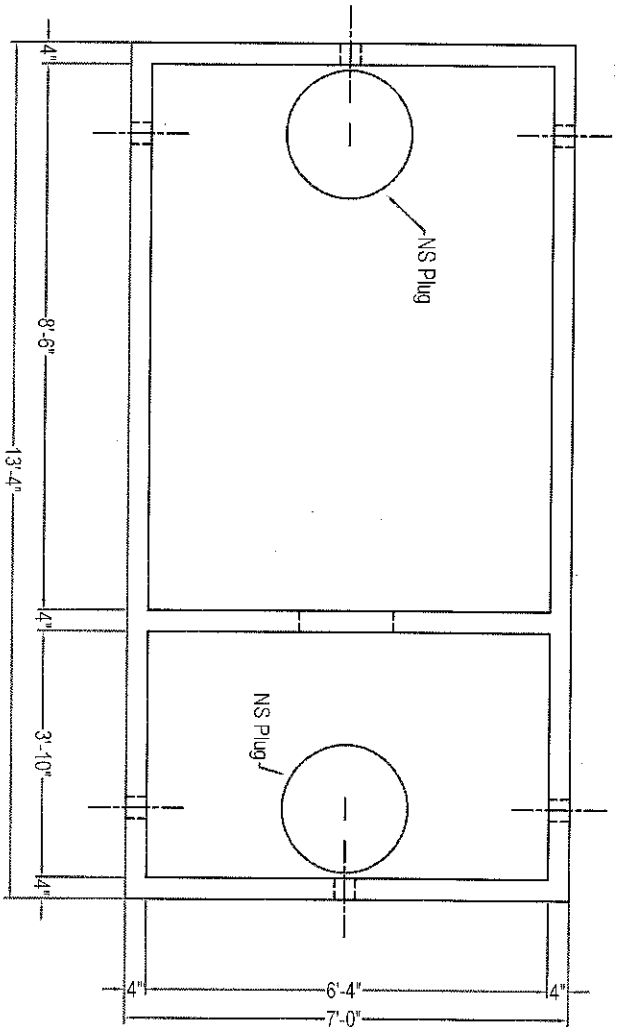

**Zeiser**  
**Wilbert**  
VAULT, INC.  
CONCRETE PRODUCTS

750 Howard Street Elmira, NY 14904  
Fax: (607) 737-0291  
Phone: (607) 733-0568  
1-800-472-4335

Title: ST 2500 Traffic  
Scale: Not To Scale

Drawn By: JPS  
Drawing No.: 04272003  
Date: 4-27-20