

BOX CULVERT

NOTES:

- Design Load: AASHTO HS-20 or as specified
- Structural Design: as specified or ASTM C-850/C-789
- Rise & Span: as specified
- Box Culvert Inserts may be cast into outside of the culvert wall if required
- All bolts are to be left in after sections are compressed together.
- Contractor should parge bolt pockets with hydraulic cement, and exterior joints should have barrier wrap placed on them.

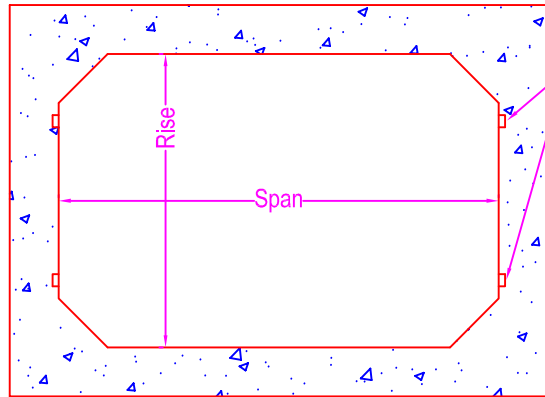

Box Culvert Inserts

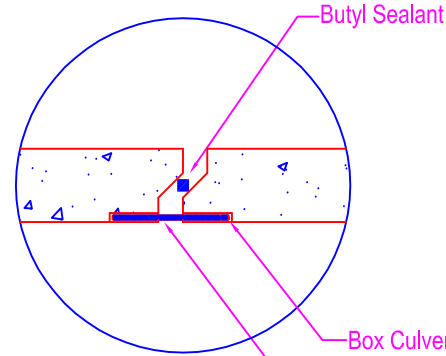

TYPICAL JOINT
DETAIL

Butyl Sealant

Box Culvert Insert

3/4" All Thread Bolt

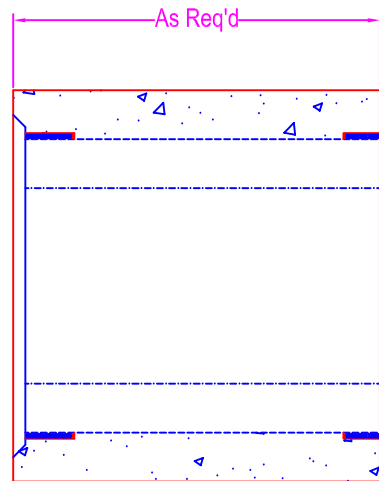
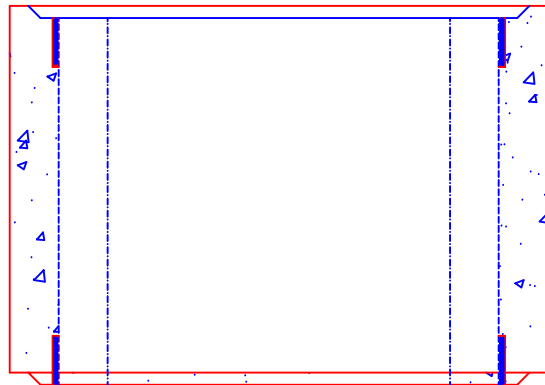

Zeiser

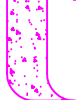

Wilbert
VAULT, INC.

CONCRETE PRODUCTS

750 Howard Street Elmira, NY 14904

Fax: (607) 737-0291

Phone: (607) 733-0568

1-800-472-4335

Title: BOX CULVERT

Scale: Not To Scale

Drawn By: JPS

Drawing No.: 1061

Date: 1-25-00