

# TRENCH DRAIN

## NOTES:

- CONCRETE: 5000 psi @ 28 days
- REF: #4 rebar @ 8" o.c. each way in all
- OPENINGS: size; type & location as req'd
- GRATING: 1-1/4" thick; banded & painted black
- designed for car & light truck traffic

Please be aware:  
drawing depicts ZWV stock trench drain  
we are able to manufacture to desired spec.

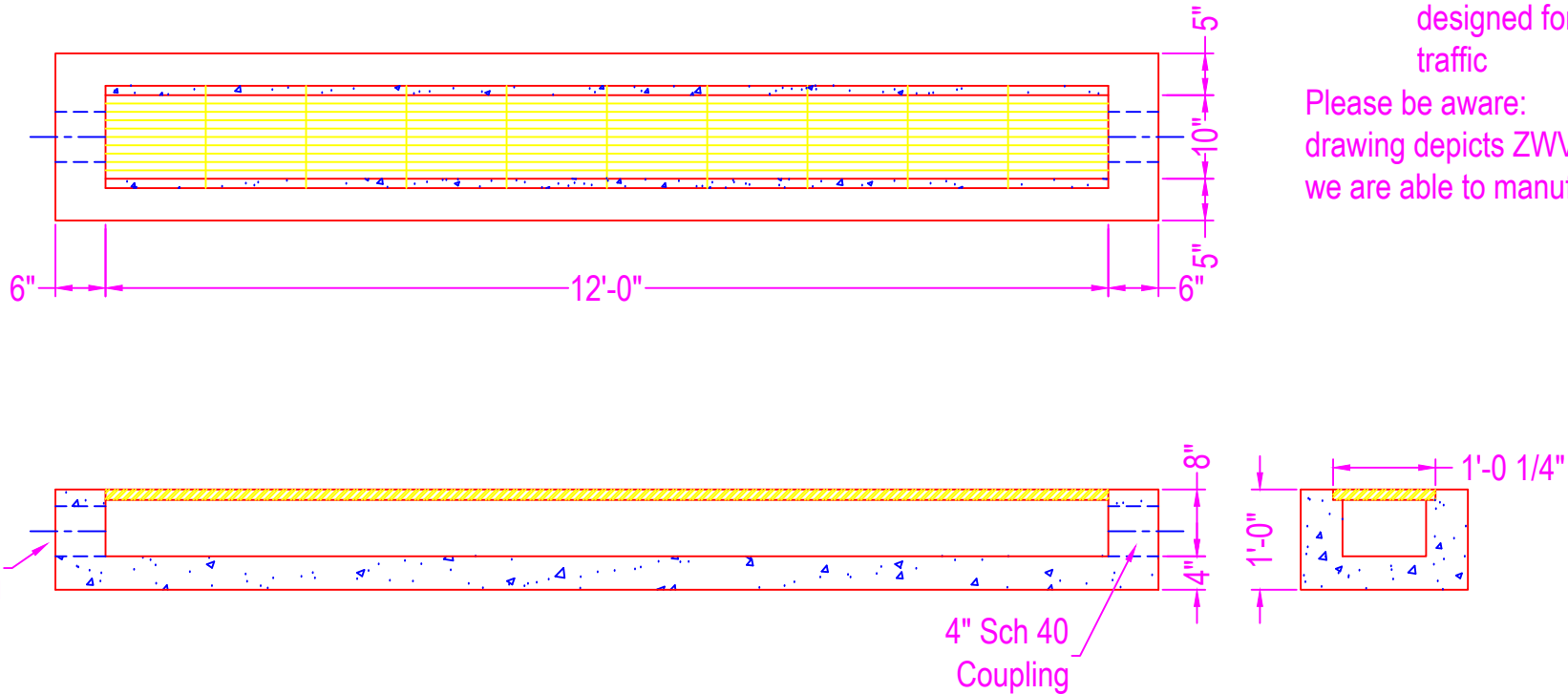

Zeiser



Wilbert  
VAULT, INC.

CONCRETE PRODUCTS

750 Howard Street Elmira, NY 14904  
Fax: (607) 737-0291  
Phone: (607) 733-0568  
1-800-472-4335

Title: Stock Trench Drain (13')

Scale: Not To Scale

Drawn By: JPS

Drawing No.: 10201400

Date: 10-20-14