

SEPTIC TANK ST-4000

NOTES:

CONCRETE: 5000 psi @ 28 days
 REF: rebar grade 60 ASTM A615
 ENTRAINED AIR: 5% to 8%
 DESIGN LOAD: AASHTO design
 LIVE LOAD: H20 traffic rating
 PIPE OPENINGS:

- pipe gasket seals
- 4" PVC - Kor-N-Seal boot
- 6" PVC - Kor-N-Seal boot
- 8" PVC - Kor-N-Seal boot
- grout filled opening
- 4" PVC - 6" coreout (grout filled in field)
- 6" PVC - 8" coreout (grout filled in field)
- 8" PVC - 12" coreout (grout filled in field)

The ultimate watertightness of the tank (grout filled pipe openings and section joint) is the responsibility of the installing contractor.

WEIGHTS:

Base: 2.99 cy = 12,600 # (approx)
 Walls: 5.72 cy = 24,000 # (approx)
 Cover: 3.99 cy = 16,800 # (approx)

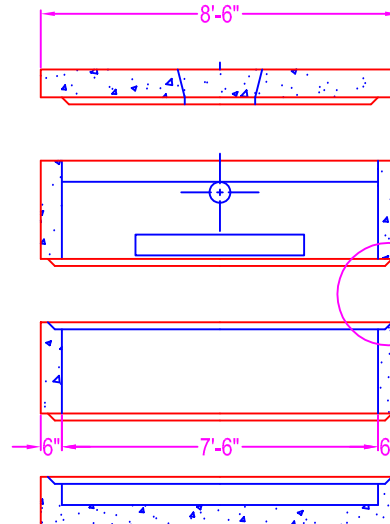
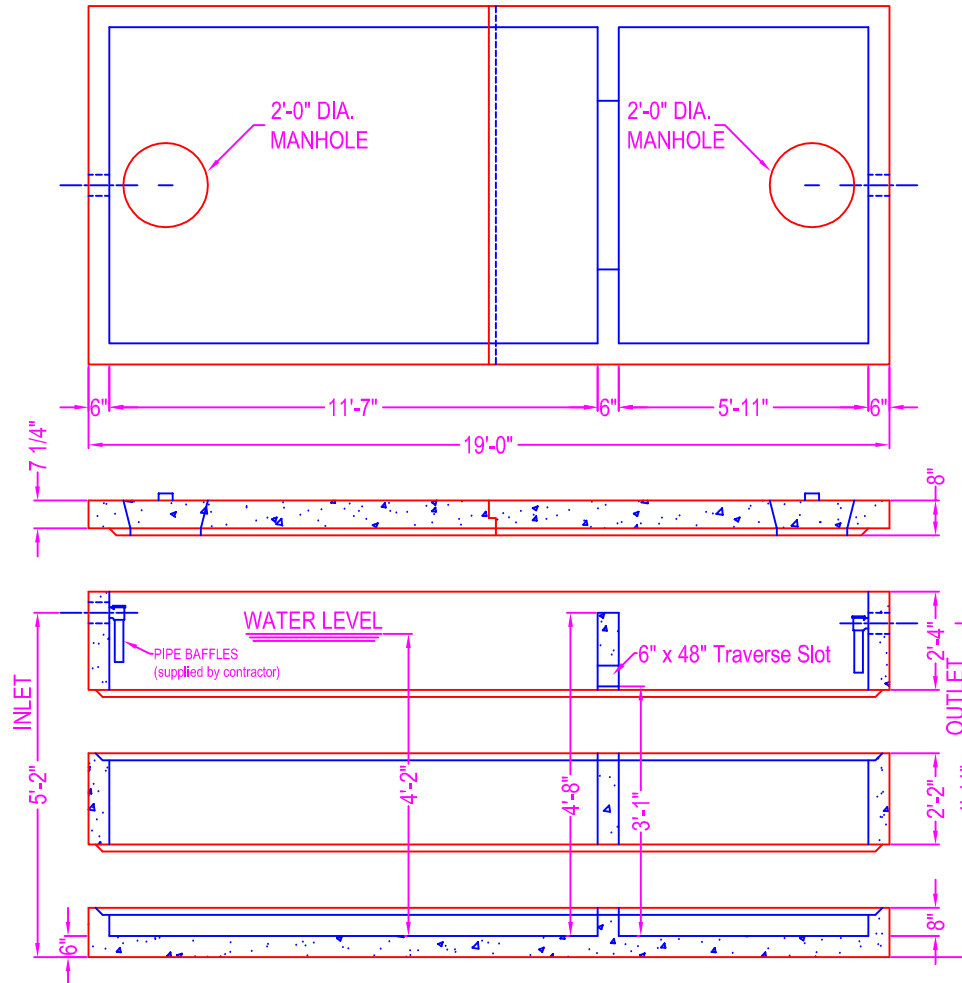

Contractor to purge interior joint w/ hydrolic non-shrink grout once tank is set in place and given time to settle

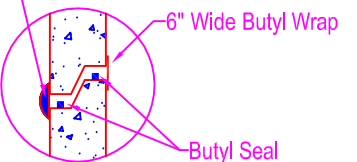

JOINT DETAIL

Joint Sealant
 Butyl Seal - Con Seal CS-102 (1") supplied by ZWV
 Butyl Wrap - Con Seal CS -213 (6" wide) supplied by ZWV (optional)
 Hydrolic non-shrink grout supplied and applied by contractor

Zeiser
Wilbert
 VAULT, INC.
 CONCRETE PRODUCTS

750 Howard Street Elmira, NY 14904
 Fax: (607) 737-0291
 Phone: (607) 733-0568
 1-800-472-4335

Title: ST-4000 H20 Traffic

Scale: Not To Scale

Drawn By: JPS

Drawing No.: 01050915

Date: 1-5-09